



24060 CASAZZA (BG)  
Via F.lli Calvi, 1 - ITALY  
Tel. ++39.035.810747  
Fax ++39.035.812679  
<http://www.agrimec.it>  
e-mail: [info@agrimec.it](mailto:info@agrimec.it)

# MULTISPAN GREENHOUSES

## *NM MODEL*



## BASIC MODULE

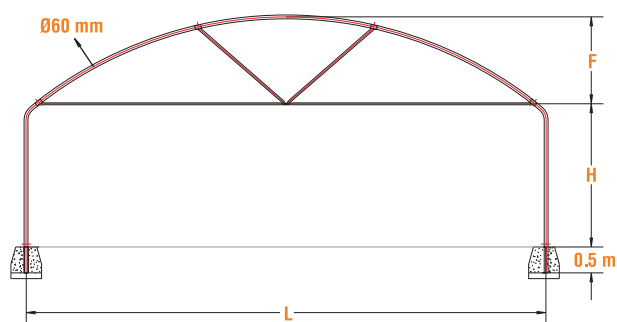

## REINFORCING ELEMENTS

Basic module can be further reinforced stiffening the pillars and the tension rods:

column reinforcement

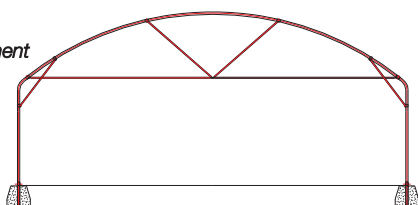

tension rods reinforcement

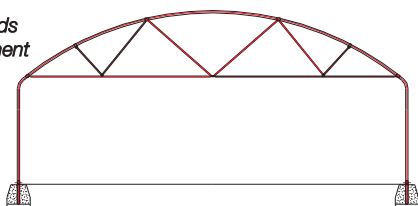

# MULTISPAN GREENHOUSES NM MODEL

## TECHNICAL SPECIFICATIONS

### Conformity:

- European norm EN 13031-1 dated 01-11-2004 "Greenhouses: Design and construction"

### Materials:

- first quality galvanized welded pipe
- steel quality E260 (EN 10305)
- **galvanization process:** Sendzimir Z 275 high resistance against corrosion

## MEASUREMENTS

Model	L (m)	H (m)	F (m)
NM 3	3		0,45
NM 4	4		0,60
NM 5	5	2,35	0,80
NM 6	6	2,75	0,95
NM 7	7	2,95	1,13
NM 8	8	3,35	1,30
NM 9	9	3,55	1,47
NM 10	10		1,64

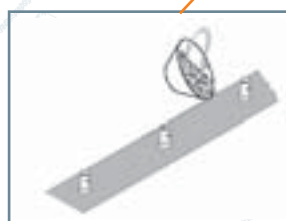
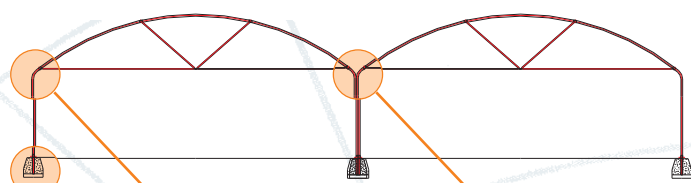

anchorage system is however practical and allows the total disassembling



column



double column



## TOP COVERING

AGRIMEC recommends **double film** for the top covering: two films separated by air inflated by small fan into the space between two films.

### Benefits of double inflated film:

- significant energy saving (30-40%)
- best resistance against hail falling
- longer duration
- easy assembling
- optimal tension of film



## FRONTS

The front frame is very important for the following reasons:

- it must be enough strong so to transfer to the main structure all the actions coming from outside, especially those one due to strong wind;
- it must be covered by long life materials since it's so easy to damage them beating with tools or tractors;
- it's the site where doors and entrances to the greenhouse are usually allocated; these doors can be made of various types.



- 1 Polycarbonate covering
- 2 Fiberglass covering
- 3 Overturnable front side
- 4 Sliding door front side

## AUTOMATIC OPERATION

Actions	Equipments	Machines	Feelers
Ventilation	natural ventilation with openings	gearmotor	thermometer anemometer (opt) rain gauge (opt)
	forced ventilation	fans	thermometer
Cooling with humidification	cooling-system	fans + submerged pump	thermometer + hygrometer (opt)
Heating	heating-system	hot air generator brucer + fan	thermometer
Humidification	nebulization	pump + solenoid valves	hygrometer
Shading	Shading-system and thermal screen	gearmotor	luxmeter + thermometer (opt)
Irrigation system	Irrigation system	pump + solenoid valves	luxmeter
Fertilizer injection	fertilizer injection	pump + solenoid valves	ph feeler / ec feeler





## WINDOWS AND AUTOMATISMS

### Importance of ventilation:

Greenhouse ventilation is useful not only to reduce the inside temperature, but also to decrease the air damp and keep constant the CO<sub>2</sub> concentration.

An high greenhouse requires a smaller number of air replacements - comparing with a low greenhouse - to obtain the same airing effect.



### Lateral plastic film roll-up window

- 1) practical solution
- 2) cheap solution
- 3) excellent solution combined with top windows (fireplace effect)



### Up-down lateral window

- 1) excellent solution for single span greenhouse not equipped with top openings
- 2) comfortable solution for the plants not exposed to direct air



Rigid material covering



### Top window

- 1) provided only with double inflated film
- 2) operation with rack
- 3) very efficient air replacement

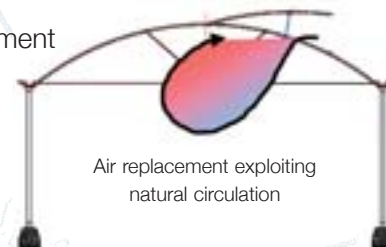

Air replacement exploiting natural circulation

wind direction -->



Air replacement exploiting external ventilation



**AGRIMEC s.n.c.**  
**di Spelgatti & C.**

24060 CASAZZA (BG)  
Via F.lli Calvi, 1 - ITALY  
Tel. ++39.035.810747  
Fax ++39.035.812679

<http://www.agrimec.it> - e-mail: [info@agrimec.it](mailto:info@agrimec.it)

Agripec is free, without any notice, to introduce any technical modification.

Local agent or dealer